



****AVAILABLE IMMEDIATELY****

****FURNISHED**** A conveniently located ground floor conversion flat in the heart of central Jesmond. Walking distance to a choice of shops, restaurants and transport links, with similar size bedrooms and available on a fully furnished basis, this great property would be ideal for or couple or individual sharers alike and is not to be missed!

The property briefly comprises a well kept communal entrance hall with access to the apartment front door. The flat itself, with laminate wood flooring throughout most of the property, has a hallway leading to; double bedroom to the front with bay window; modern bathroom WC with spotlighting; second double bedroom central to the property; comfortable lounge to the rear off-shoot leading to a fitted kitchen with appliances. Externally there is a shared yard to the rear and on street permit parking to the front.

Available Immediately | £1,000pcm | Ground Floor Conversion Flat | Two Double Bedrooms | 695 Sq. ft (64.6m²) | Bathroom WC | Kitchen | Lounge | Wood Flooring | On Street Permit Parking | Furnished | GCH & DG | Council Tax Band: B | EPC Rating: D

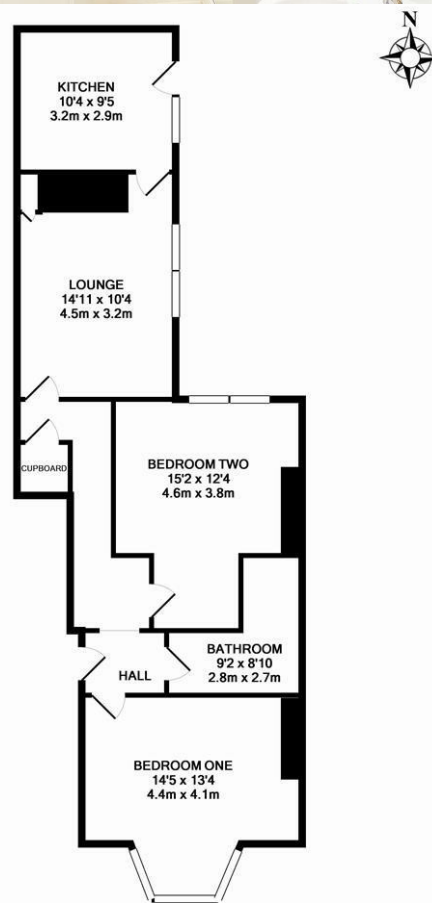
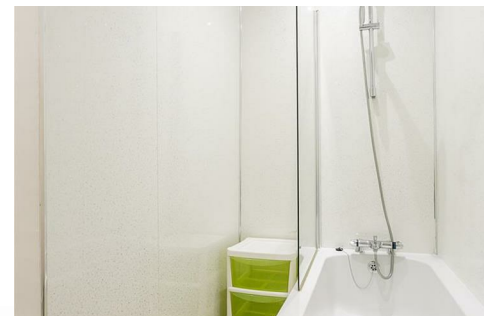

TOTAL APPROX. FLOOR AREA 695 SQ.FT. (64.6 SQ.M.)
Whilst every attempt has been made to ensure the accuracy of the floor plan contained here, measurements of doors, windows, rooms and any other items are approximate and no responsibility is taken for any error, omission, or mis-statement. This plan is for illustrative purposes only and should be used as such by any prospective purchaser. The services, systems and appliances shown have not been tested and no guarantee as to their operability or efficiency can be given.
Made with Metropix ©2016

£1,000 PCM

IMPORTANT NOTE: These particulars and the descriptions and measurements herein do not constitute representation and whilst every effort has been made to ensure accuracy, this cannot be guaranteed.

